

PRESENTATION – PRÉSENTATION – ANSICHT

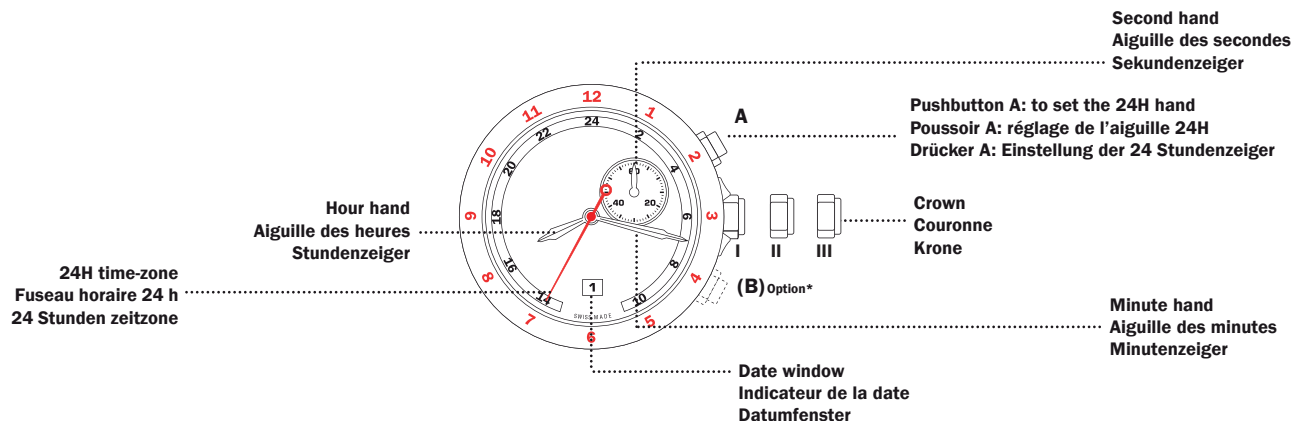

**SETTING THE TIME  
HOUR AND MINUTE**

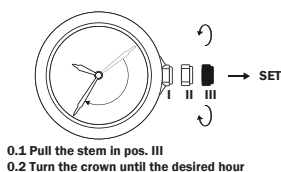

**REGLAGE DE L'HEURE  
ET MINUTE**

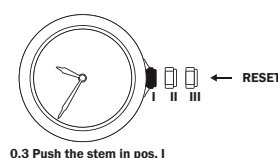

**EINSTELLEN DER ZEITANZEIGE  
STUNDEN UND MINUTEN**

**SETTING THE DATE**  
CAUTION: NEVER CORRECT DATE  
BETWEEN 9 PM AND 0.30 AM.

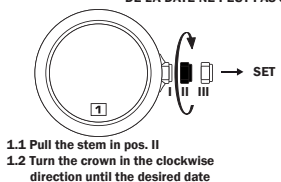

**CORRECTION DE LA DATE**  
ATTENTION: LA CORRECTION  
DE LA DATE NE PEUT PAS SE FAIRE ENTRE 21H00 ET 0H30.

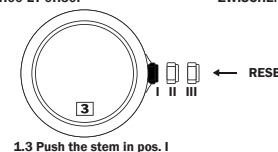

**EINSTELLEN DES DATUMS**  
ACHTUNG: DATUM NICHT  
ZWISCHEN 21. UHR UND 0.30 UHR  
EINSTELLEN.

**2nd TIME ZONE**

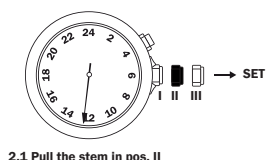

**2eme FUSEAU HORAIRE**

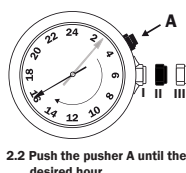

**ZWEITE ZEITZONE**

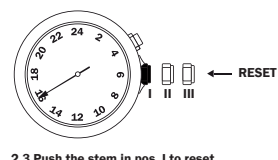

Option\*: Possibility of replacing pushbutton A by pushbutton B  
Option\*: Possibilité de remplacer le pousoir A par le pousoir B  
Option\*: Möglichkeit den drücker A mit dem drücker B zu ersetzen